

1 2 3 4 5 6

A

B

C

D

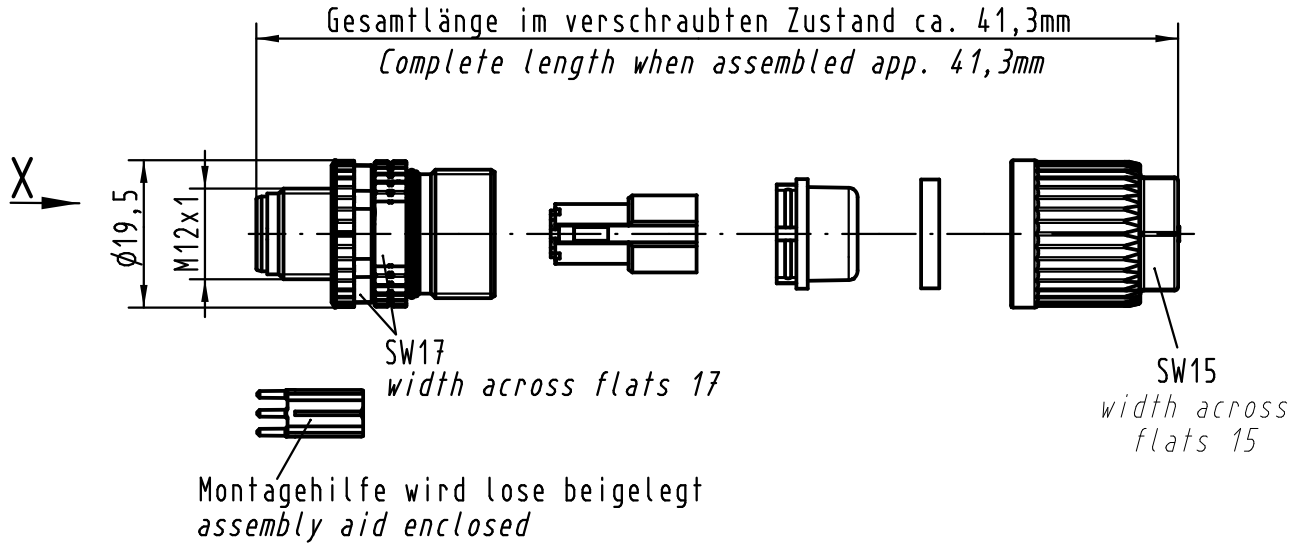

X (2:1)

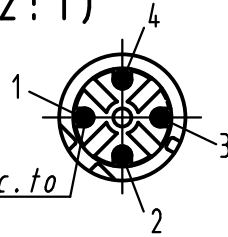

Steckgesicht n.  
Contact face acc. to  
IEC 61076-2-101

Crimpkontakte separat bestellen  
Order contacts separately

Kabel $\phi$ / Cable $\phi$	Leiterquerschnitt Wire gauge	Bestell-Nr. Part-No.
5,5-7,2mm		
Dichtung / Sealing	AWG 26-22	09 67 000 5576
schwarz / black	AWG 24-20	09 67 000 8576

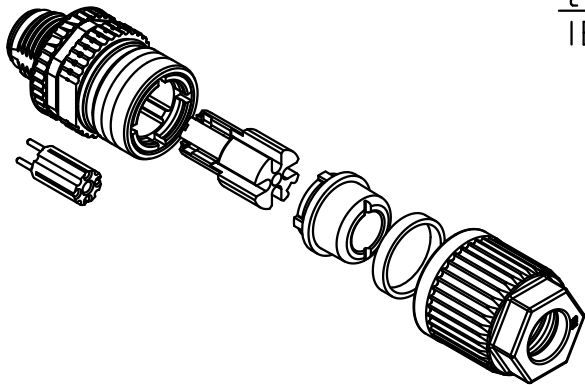

All Dimensions in mm Original Size DIN A 4			Techn. Character.			Nicht tolerierte Maß/Free size tolerances		
EC04038	11.11.11	DY		Dat.	Name	Maßstab/Scale <b>1:1</b>	<b>M12-L</b> RSV geschirmt, Stift, D-kodiert, 4-polig, crimp Circular Connector shielded, male, D-coded, 4-pole, crimp	Blatt/ page /
EC03244	20.05.11	DY	Detail.	15.10.08	DY			
EC02560	15.11.10	DY	Insp.		SR			
EC01106	23.11.09	DY	Stand.					
414337	17.06.09	DY	HARTING Electronics GmbH & Co. KG				<b>TB 21 03 882 1406</b>	Sub.
414236			D-32339 ESPELKAMP					
Mod.	Dat.	Name						